

Heeho

Guangzhou Heeho Doors Company Limited

HEEHO Polycarbonate roller shutter doors



▲ HH-PC300 / HH-PC250

- HEEHO Transparent polycarbonate roller shutter doors are made of a special design with reinforced stainless steel tubes inserted or aluminum joining tubes between the polycarbonate slats.
- Our design and material make our polycarbonate roller shutter doors extremely strong and resistant to forced entry.
- It's ideal for where the visibility and security are required, such as shops, retail stores, jewelry stores, showrooms, banks, Bar and Reception tops, kiosks, etc

Benefits:

- Superior visibility. Better than any other type of roller shutter doors
- High security and exceptional strong. As strong as steel roller shutter doors.
- UV-Stabilized and Sun resistant. 80% of the ultraviolet will be resisted and retains its transparency for many years
- High impact-resistance. Can withstand the impact of a car driving into it with 30 miles an hour.
- Scratch-resistant. Won't scratch under normal use.
- Environmentally friendly. 100% recyclable
- Fire retardant . Being almost non-flammable, self-extinguishing and low smoke toxicity.
- Advertising effect. 24/7 free advertising.

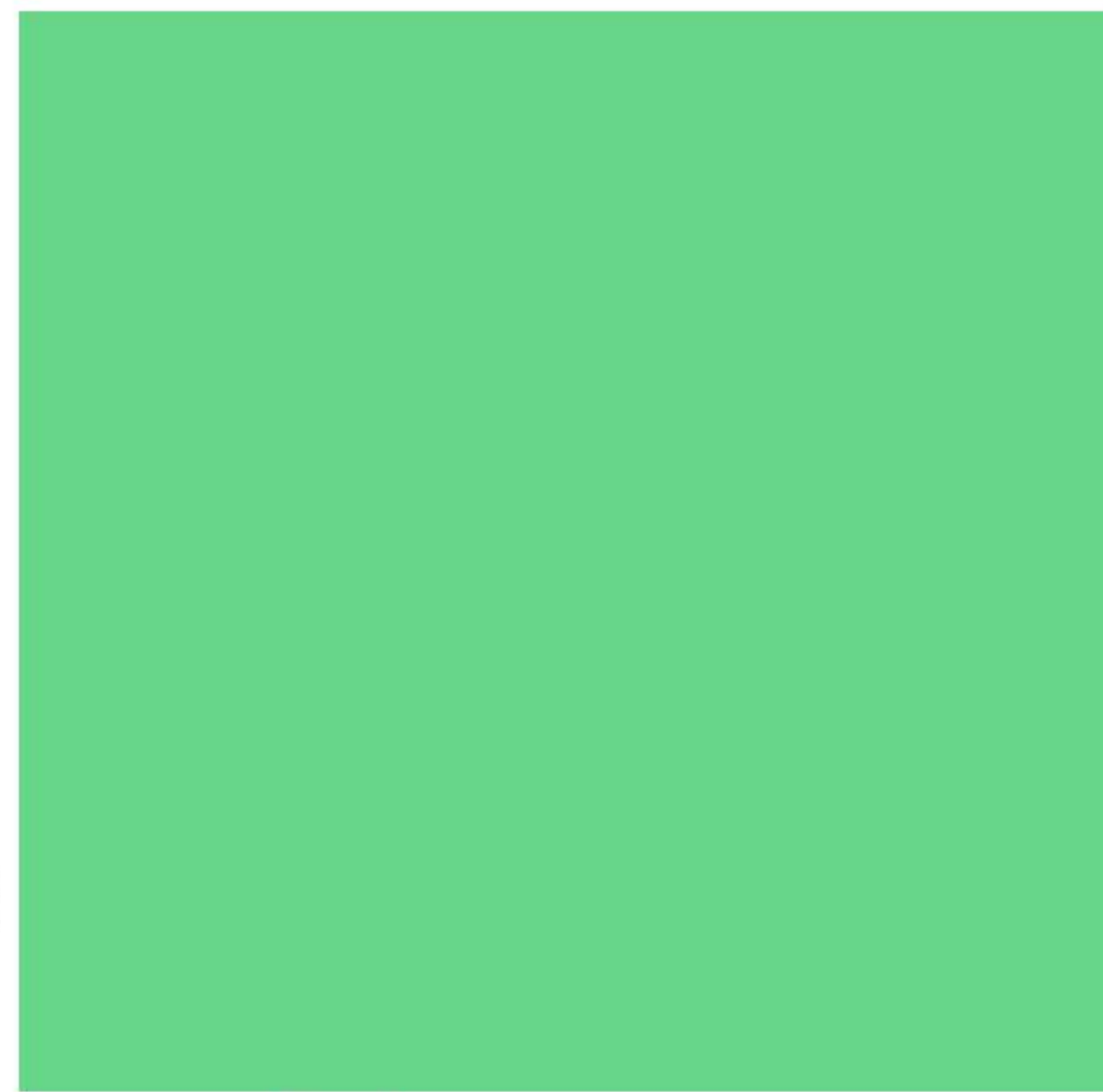

▼ HH-PC100



▲ HH-PC305



HH-PC300/HH-PC250

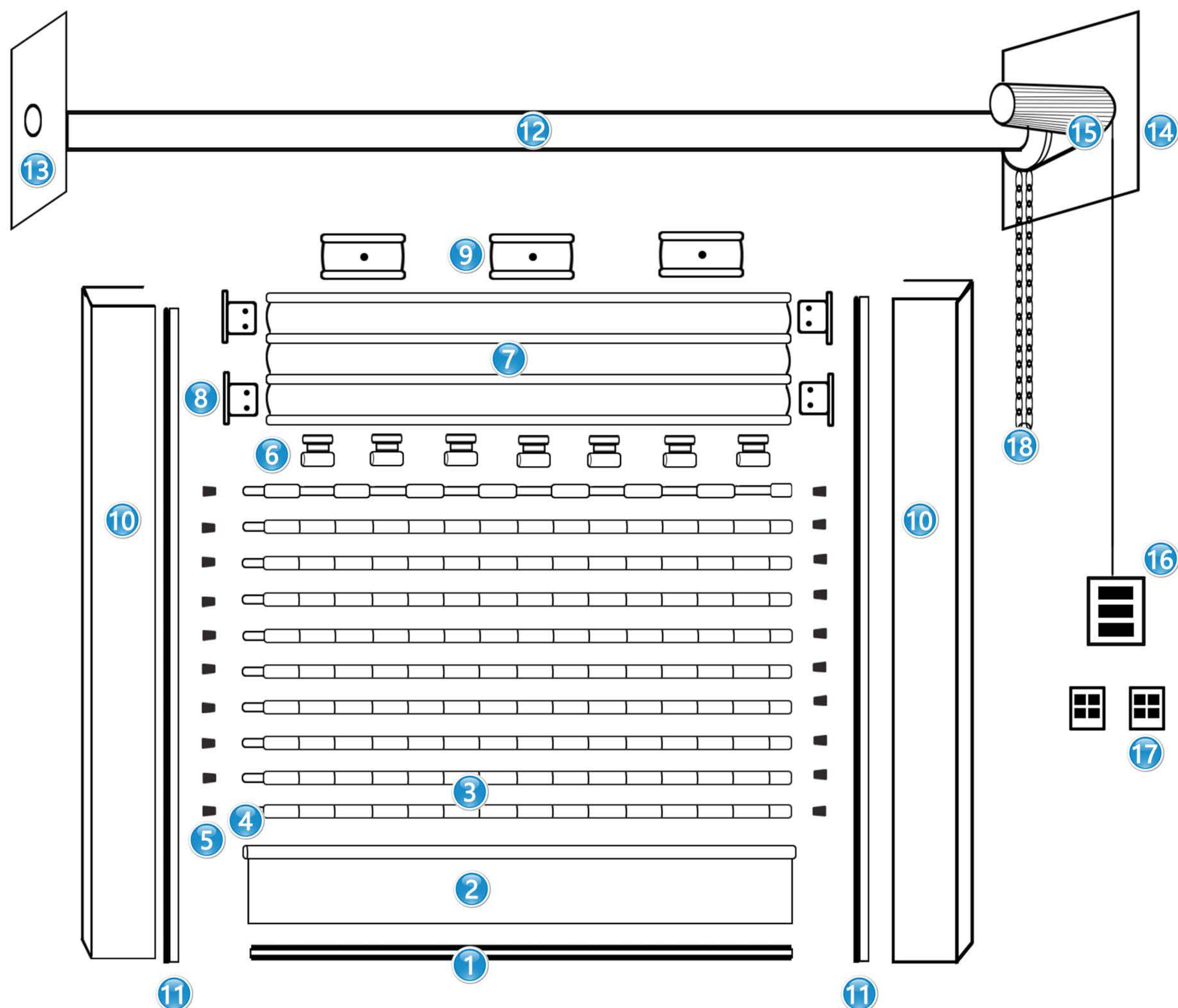

- | | |
|-------------------------|------------------------|
| ① Rubber weather seal | ⑩ Aluminum guide rail |
| ② Aluminum bottom rail | ⑪ Brush strip |
| ③ Polycarbonate slat | ⑫ Shaft(roller drum) |
| ④ Stainless steel tube | ⑬ Left side plate |
| ⑤ Plastic end clip | ⑭ Right side plate |
| ⑥ Top bridging hook | ⑮ Roller shutter moter |
| ⑦ Galvanized steel slat | ⑯ Switch button |
| ⑧ Steel end clip | ⑰ Remote control |
| ⑨ Galvanized steel slat | ⑱ Manual hoist chain |

HH-PC305

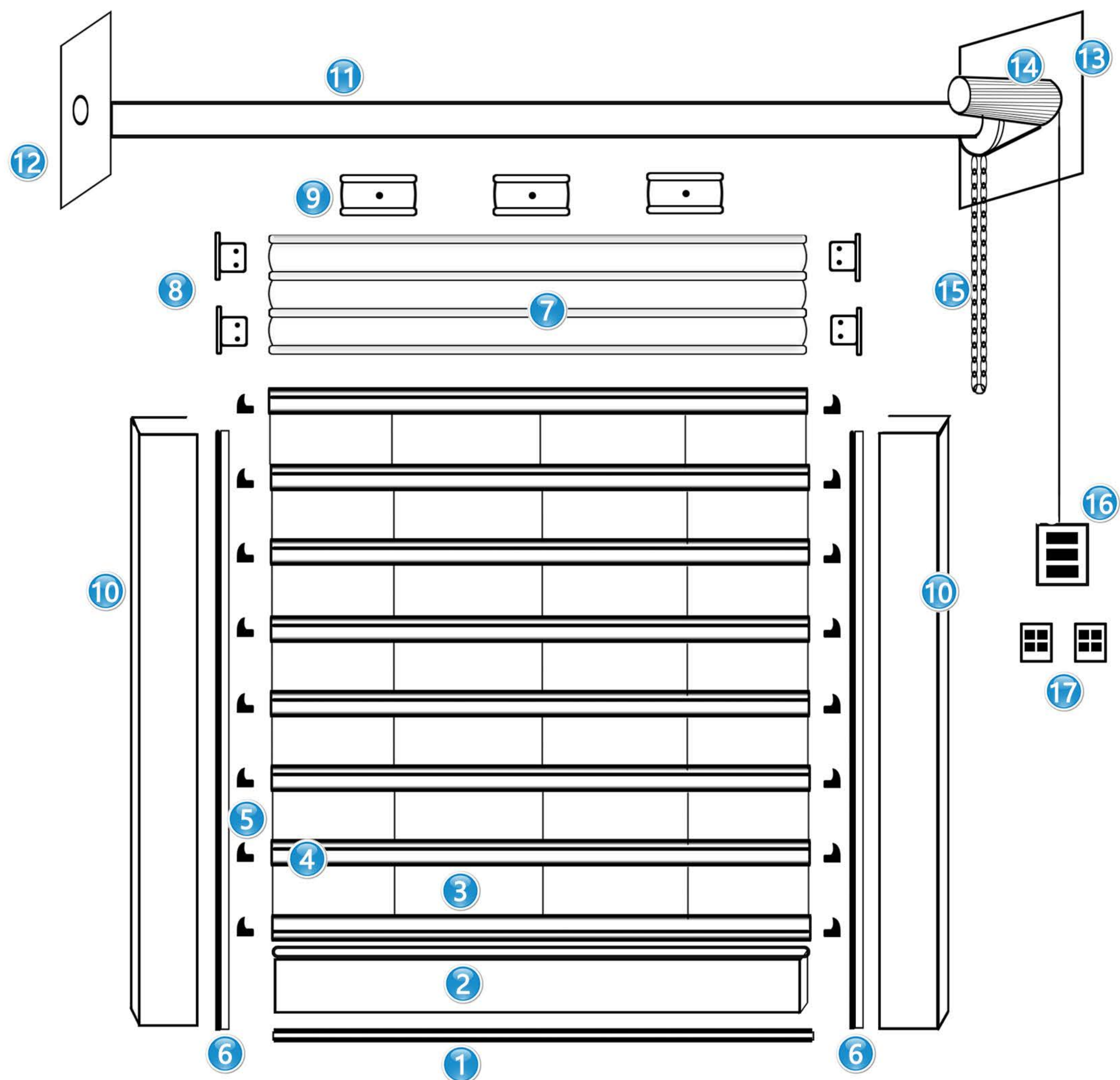



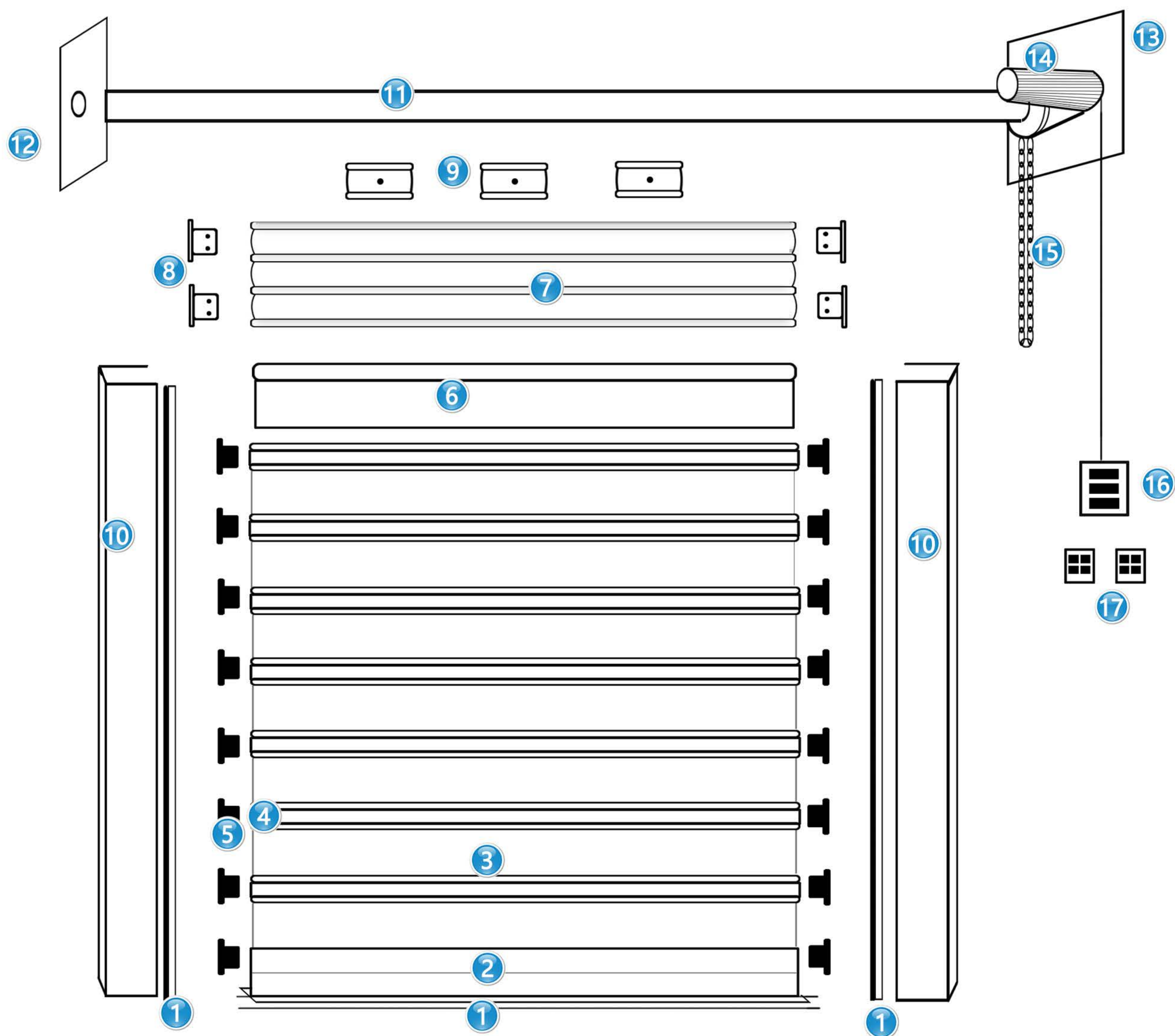

- | | |
|-------------------------|------------------------|
| ① Rubber weather seal | ⑩ Aluminum guide rail |
| ② Aluminum bottom rail | ⑪ Shaft(roller drum) |
| ③ Polycarbonate slat | ⑫ Left side plate |
| ④ Aluminum joining tube | ⑬ Right side plate |
| ⑤ Plastic end clip | ⑭ Roller shutter moter |
| ⑥ Aluminum brush strip | ⑮ Manual hoist chain |
| ⑦ Galvanized steel slat | ⑯ Switch button |
| ⑧ Steel end clip | ⑰ Remote control |
| ⑨ Galvanized steel slat | |

HH-PC100

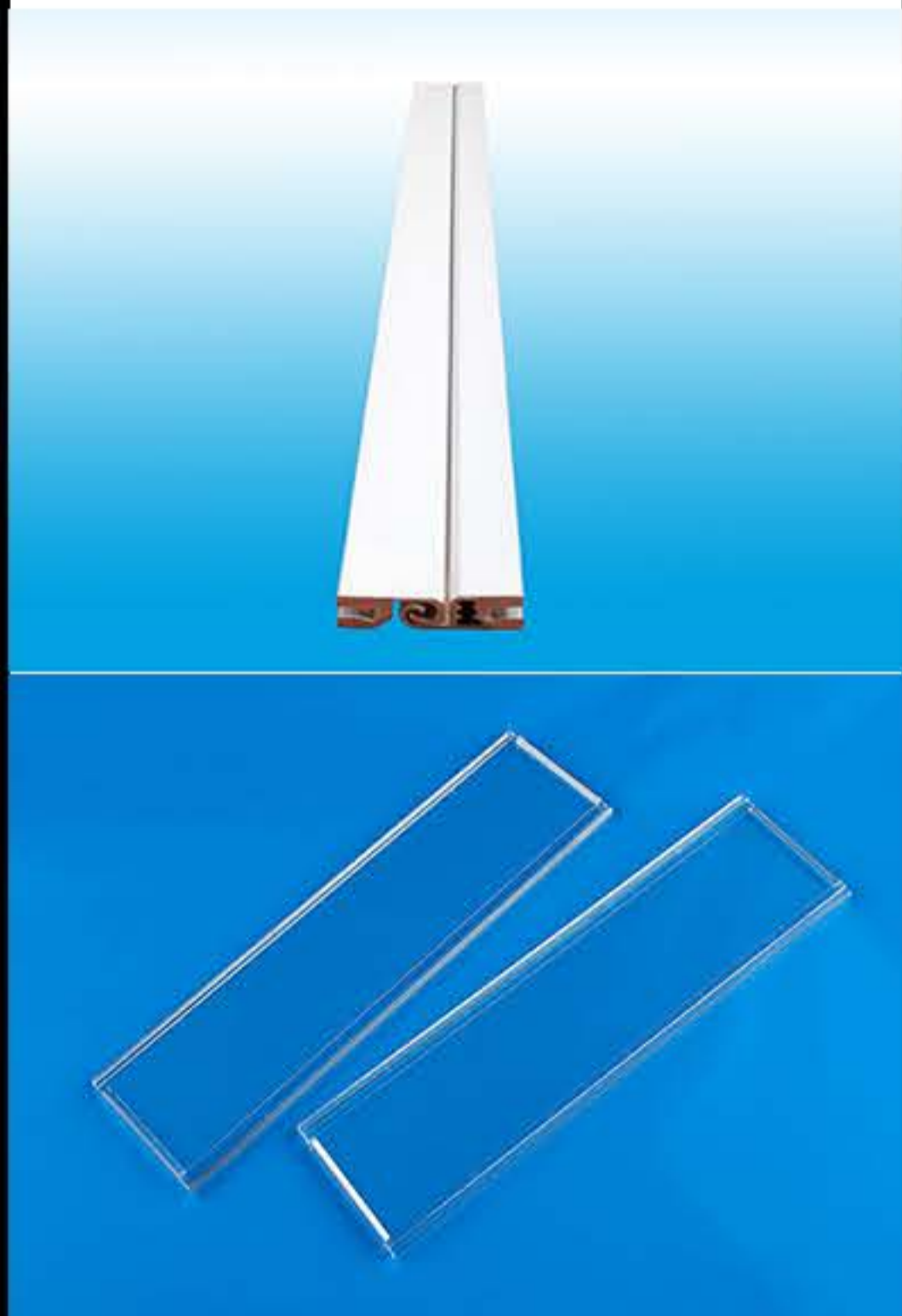

- | | |
|-------------------------|------------------------|
| ① Brush strip | ⑩ Aluminum guide rail |
| ② Aluminum bottom rail | ⑪ Shaft |
| ③ Polycarbonate slat | ⑫ Left side plate |
| ④ Aluminum joining tube | ⑬ Right side plate |
| ⑤ Plastic end clip | ⑭ Roller shutter moter |
| ⑥ Top bridging hook | ⑮ Manual hoist chain |
| ⑦ Galvanized steel slat | ⑯ Switch button |
| ⑧ Steel end clip | ⑰ Remote control |
| ⑨ Galvanized steel slat | |

Product specifications & Data sheet

Item number	Item picture	construction	operation way	optional	Finish	Max width* height (mm)
HH-PC250		<p>*Curatin: Manufactured from 250mm x 107.50 mm, 2.2 mm thickness polycarbonate slats, linked together by 12.7 mm diameter horizontal stainless steel tubes, with plastic end clips on both sides</p> <p>*Bottom rail: Aluminium bottom rail with brush strips</p> <p>*Guide rail: Aluminium guide rail with brush strips.</p> <p>*shaft: Instead of GI roller shaft, we are using galvanized steel shafts for all of our polycarbonate roller shutter doors, which has better performance for rust protection.</p>	<p>*Manual operation: Push up and down by hand</p> <p>*Automatic operation: switch button, remote control, manual hoist chain if case of power failure</p>	<p>*shutter box</p> <p>*Cover box for switch button</p> <p>*photocell</p> <p>*reserve power supply</p> <p>*Blocked rebound device</p> <p>*safety brake</p> <p>*video surveillance</p>	<p>*Aluminum profiles: Powder coating, Anodized, electrophoresis</p> <p>*Polycarbonate slat: transparent</p>	5000 * 5000
HH-PC300		<p>*Curatin: Manufactured from 300mm x 115mm, 3.0 mm thickness polycarbonate slats, linked together by 16 mm diameter horizontal stainless steel tubes.</p> <p>*Bottom rail: Aluminium bottom rail with brush strips.</p> <p>*Guide rail: Aluminium guide rail with brush strips.</p> <p>*shaft: Instead of GI roller shaft, we are using galvanized steel shafts for all of our polycarbonate roller shutter doors, which has better performance for rust protection.</p>	<p>*Manual operation: Push up and down by hand</p> <p>*Automatic operation: switch button, remote control, manual hoist chain if case of power failure</p>	<p>*shutter box</p> <p>*Cover box for switch button</p> <p>*photocell</p> <p>*reserve power supply</p> <p>*Blocked rebound device</p> <p>*safety brake</p> <p>*video surveillance</p>	<p>*Aluminum profiles: Powder coating, Anodized, electrophoresis</p> <p>*Polycarbonate slat: transparent</p>	12000 * 9000
HH-PC350		<p>*Curatin: Manufactured from 304.60mm x 83.10 mm, 3.6 mm thickness polycarbonate slats, linked together by 2.5 mm thickness double tubes, with plastic end clips on both sides</p> <p>*Bottom rail: Aluminium bottom rail with brush strips.</p> <p>*Guide rail: Aluminium guide rail with brush strips.</p> <p>*shaft: Instead of GI roller shaft, we are using galvanized steel shafts for all of our polycarbonate roller shutter doors, which has better performance for rust protection.</p>	<p>*Manual operation: Push up and down by hand</p> <p>*Automatic operation: switch button, remote control, manual hoist chain if case of power failure</p>	<p>*shutter box</p> <p>*Cover box for switch button</p> <p>*photocell</p> <p>*reserve power supply</p> <p>*Blocked rebound device</p> <p>*safety brake</p> <p>*video surveillance</p>	<p>*Aluminum profiles: Powder coating, Anodized, electrophoresis</p> <p>*Polycarbonate slat: transparent</p>	7000 * 7000
HH-PC100		<p>*Curatin: Manufactured from 100 mm height continuous, 2 mm thickness polycarbonate slats, linked together by 1.2 mm thickness aluminum tubes, with plastic end clips on both sides</p> <p>*Bottom rail: Aluminium bottom rail with brush strips.</p> <p>*Guide rail: Aluminium guide rail with brush strips.</p> <p>*shaft: Instead of GI roller shaft, we are using galvanized steel shafts for all of our polycarbonate roller shutter doors, which has better performance for rust protection.</p>	<p>*Manual operation: Push up and down by hand</p> <p>*Automatic operation: switch button, remote control, manual hoist chain if case of power failure</p>	<p>*shutter box</p> <p>*Cover box for switch button</p> <p>*photocell</p> <p>*reserve power supply</p> <p>*Blocked rebound device</p> <p>*safety brake</p> <p>*video surveillance</p>	<p>*Aluminum profiles: Powder coating, Anodized, electrophoresis</p> <p>*Polycarbonate slat: transparent</p>	6900 * 7000



Heeho

Guangzhou Heeho Doors Company Limited

Tel: +86-20-39004566

E-mail: info@heehorollershutter.com

Website: www.heehorollershutter.com

Add: No.C112-C116 Tainan Road, NanSha District, Guangzhou, China